



**NOTICE OF CONSIDERATION OF
SITE PLAN PROPOSAL**

**BLOOMFIELD VEIN & VASCULAR, PLLC
43572 WOODWARD AVENUE
(SIDWELL NO: 19-04-429-005)**

PLEASE TAKE NOTICE THAT a public meeting will be held by the Board of Trustees of the Charter Township of Bloomfield, Oakland County, Michigan on **MONDAY, MAY 22, 2023, at 7:00 p.m.**, in the auditorium at the Bloomfield Township Hall. Street address: 4200 Telegraph Road, Bloomfield Hills, MI 48302.

At the meeting, the Board will consider a site plan request to construct a new office building on the east side of Woodward Avenue and north of Square Lake Road.



Watch BCTVLive



Agenda & Packet

Comments regarding this proposal may be provided at the public meeting, submitted via email to publiccomment@bloomfieldtp.org or by contacting the Planning Division at (248) 433-7795.

Materials for the Board meeting will be made available to the public on the Township's Documents of Demand webpage by the close of business on Thursday, May 18, 2023. The Quick Response ("QR") Codes, provided above, can be utilized to view the meeting's proceedings and materials.

NOTE: The Charter Township of Bloomfield will provide necessary, reasonable auxiliary aids and services at all meetings to individuals with disabilities. All such requests must be made at least five days prior to said meeting. Individuals with disabilities requiring auxiliary aids or services should contact Bloomfield Township by writing or calling the following: Letter • Bloomfield Township Clerk's Office, 4200 Telegraph Road, Bloomfield Hills, MI 48302. Email • clerk@bloomfieldtp.org Phone • 248-433-7702.

**MARTIN C. BROOK
BLOOMFIELD TOWNSHIP CLERK**

Post: 5-15-2023

U.S. Mail: 5-4-2023

Bloomfield Township
43572 Woodward Avenue
39 Labels



MAP LEGEND:

- LOT LINES
- MARSH - SWAMP
- ROAD EDGE - PLANIMETRICS - 2000
- TOWNSHIP LIMITS
- SUB DIVISIONS
- RIVERS - STREAMS
- OPEN WATER
- BUILDING OUTLINE
- PONTIAC AGREEMENT
- PARCELLAYER
- NO THROUGH ROADS
- RIGHT-OF-WAY



Map Scale: 1 inch = 394 feet
Map Date: 5/02/2023
Data Date: April 19, 2023
Sources: Bloomfield Township, Oakland County GIS Utility, River's Edge GIS, LLC.

Disclaimer: This map was prepared for reference purposes only. It was compiled from a variety of available sources with varying degrees of accuracy. It is not a legally recorded map or survey and is not intended to be used for legal purposes. The Township assumes no responsibility for errors that arise from the use of the data.

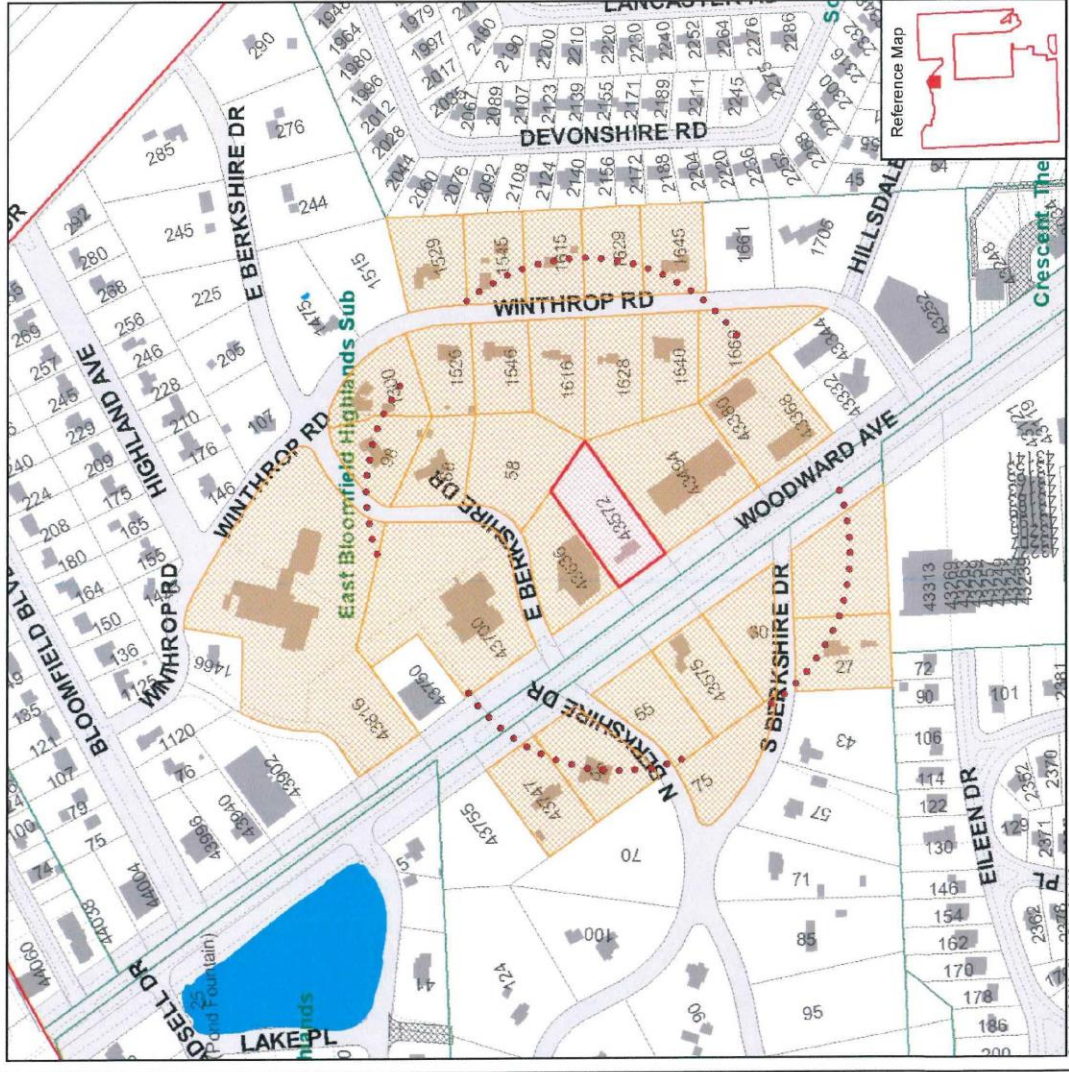

Copyright © 2005 - River's Edge GIS, LLC