



**NOTICE OF CONSIDERATION OF
SITE PLAN & SPECIAL LAND USE PROPOSAL**

**PRIMROSE DAY CARE
6255 TELEGRAPH ROAD
(SIDWELL NO: 19-28-351-047)**

PLEASE TAKE NOTICE THAT a PUBLIC HEARING will be held by the Board of Trustees of the Charter Township of Bloomfield, Oakland County, Michigan on **MONDAY, FEBRUARY 12, 2024, at 7:00 p.m.**, in the auditorium at the Bloomfield Township Hall, 4200 Telegraph Road, Bloomfield Hills, MI 48302.

At the hearing, the Board will be considering a site plan and special land use request to construct a new Primrose Day Care facility, 6255 Telegraph Rd, located on the east side of Telegraph Road and north of Maple Road.



Comments regarding this proposal may be provided at the public hearing, submitted via email to publiccomment@bloomfieldtp.org or by contacting the Planning Division at (248) 433-7795.

Materials for the Board meeting and public hearing will be made available to the public on Bloomfield Township's [Documents of Demand webpage](#) by the close of business on Thursday, February 8, 2024. Meetings are broadcasted live through [Bloomfield Community Television](#) on Comcast's channel 15 for residents of Bloomfield Township. The links and Quick Response ("QR") codes provided above can be utilized to view the meeting's materials and proceedings.

NOTE: The Charter Township of Bloomfield will provide necessary, reasonable auxiliary aids and services at all meetings to individuals with disabilities. All such requests must be made at least five days prior to said meeting. Individuals with disabilities requiring auxiliary aids or services should contact Bloomfield Township by writing or calling the following: Letter • Bloomfield Township Clerk's Office, 4200 Telegraph Road, Bloomfield Hills, MI 48302. Email • clerk@bloomfieldtp.org Phone • 248-433-7702.

**MARTIN C. BROOK
BLOOMFIELD TOWNSHIP CLERK**

Post: 1-25-2024

Publish: 1-28-2024

U.S. Mail: 1-25-2024

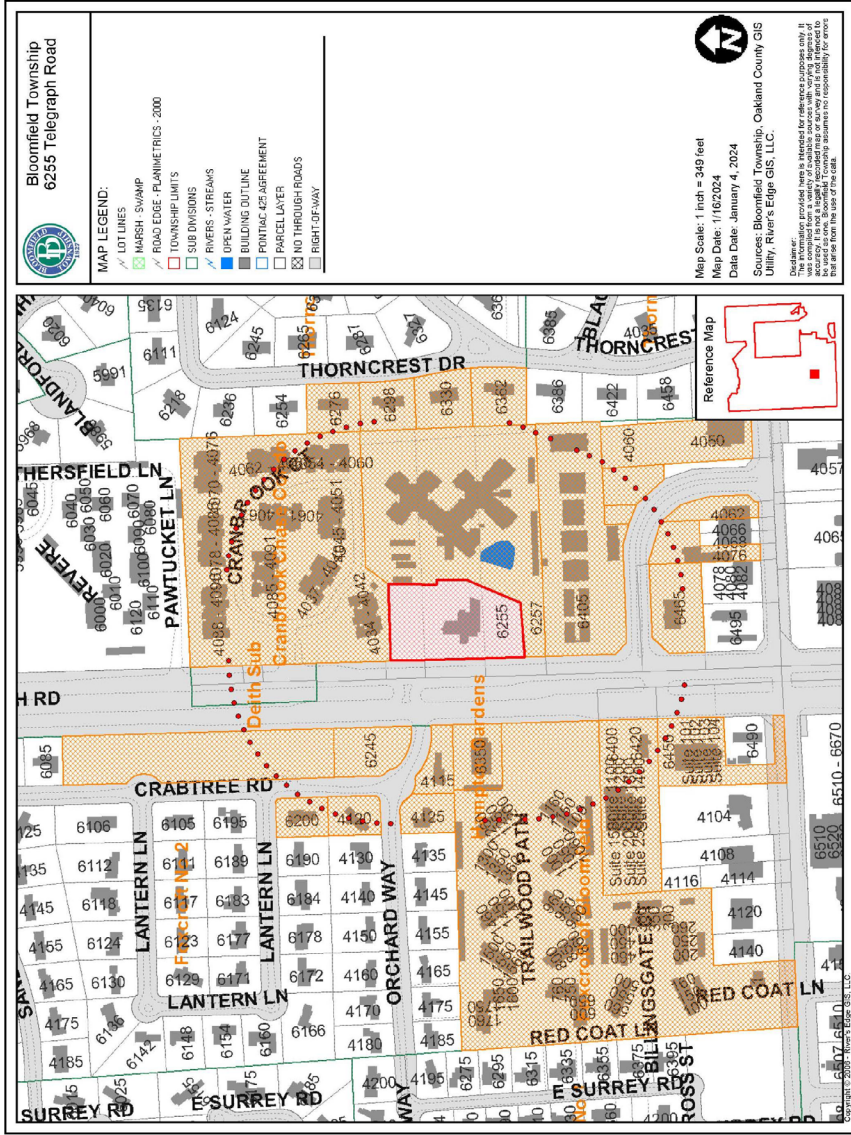

Bloomfield Township
6255 Telegraph Road

MAP LEGEND:

- LOT LINES
- ROAD EDGE - PLANNING METRICS - 2000
- TOWNSHIP LIMITS
- SUB DIVISIONS
- RIVERS - STREAMS
- OPEN WATER
- BUILDING OUTLINE
- PROTECTIVE AGREEMENT
- PARCEL LAYER
- NO THROUGH ROADS
- RIGHT-OF-WAY
- MARSH - SWAMP



Map Scale: 1 inch = 349 feet
Map Date: 1/16/2024
Data Date: January 4, 2024
Sources: Bloomfield Township, Oakland County GIS Utility, River's Edge GIS, LLC.

Disclaimer:
The information provided here is intended for reference purposes only. It is not a legal document and should not be used as a basis for any legal action. The information is provided as is, without warranty of any kind, express or implied, including but not limited to accuracy, completeness, or suitability for any purpose. The user assumes all responsibility for errors or omissions from the use of the data.

Reference Map

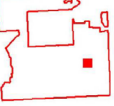

Copyright © 2024 - River's Edge GIS, LLC