



**CHARTER TOWNSHIP OF BLOOMFIELD
NOTICE OF HEARING OF NECESSITY
ON SPECIAL ASSESSMENT IMPROVEMENTS**

**PUBLIC WATER MAIN PROJECT FOR SOUTH BLOOMFIELD HIGHLANDS SUBDIVISION
SPECIAL ASSESSMENT DISTRICT NO. 601**

TO THE OWNERS OF THE FOLLOWING LISTED PROPERTIES:

PIN	ADDRESS
1903302013	1916 DEVONSHIRE RD
1903302014	1932 DEVONSHIRE RD
1903302015	1948 DEVONSHIRE RD
1903302016	1964 DEVONSHIRE RD
1903302017	1980 DEVONSHIRE RD
1903302018	1996 DEVONSHIRE RD
1903302019	2012 DEVONSHIRE RD
1903302020	2028 DEVONSHIRE RD
1903302021	2044 DEVONSHIRE RD
1903302022	2060 DEVONSHIRE RD
1903302023	2076 DEVONSHIRE RD
1903302024	2092 DEVONSHIRE RD
1903302025	2108 DEVONSHIRE RD
1903302026	2124 DEVONSHIRE RD
1903302027	2140 DEVONSHIRE RD
1903302028	2156 DEVONSHIRE RD
1903302029	2172 DEVONSHIRE RD
1903302030	2188 DEVONSHIRE RD
1903302031	2204 DEVONSHIRE RD
1903302032	2220 DEVONSHIRE RD
1903302033	2236 DEVONSHIRE RD
1903302034	2252 DEVONSHIRE RD
1903302035	2268 DEVONSHIRE RD
1903302036	2284 DEVONSHIRE RD
1903302037	2300 DEVONSHIRE RD
1903302038	2316 DEVONSHIRE RD
1903302039	2332 DEVONSHIRE RD
1903302040	2348 DEVONSHIRE RD
1903302041	2364 DEVONSHIRE RD
1903302042	45 HILLSDALE RD
1903302043	55 HILLSDALE RD
1903302044	61 HILLSDALE RD
1903302045	65 HILLSDALE RD
1903302046	75 HILLSDALE RD
1903302047	95 HILLSDALE RD
1903302050	151 MARLBOROUGH DR
1903302051	159 MARLBOROUGH DR
1903303001	1915 DEVONSHIRE RD
1903303002	1933 DEVONSHIRE RD
1903303003	1949 DEVONSHIRE RD
1903303004	1965 DEVONSHIRE RD
1903303005	1979 DEVONSHIRE RD
1903303006	1997 DEVONSHIRE RD
1903303007	2017 DEVONSHIRE RD
1903303008	2035 DEVONSHIRE RD
1903303009	2067 DEVONSHIRE RD
1903303010	2089 DEVONSHIRE RD
1903303011	2107 DEVONSHIRE RD
1903303012	2123 DEVONSHIRE RD
1903303013	2139 DEVONSHIRE RD
1903303014	2155 DEVONSHIRE RD
1903303015	2171 DEVONSHIRE RD
1903303016	2189 DEVONSHIRE RD
1903303017	2211 DEVONSHIRE RD
1903303018	2245 DEVONSHIRE RD
1903303019	2275 DEVONSHIRE RD
1903303020	415 MARLBOROUGH DR
1903303021	2130 LANCASTER RD
1903303022	2140 LANCASTER RD
1903303023	2150 LANCASTER RD
1903303024	2160 LANCASTER RD
1903303025	2170 LANCASTER RD
1903303026	2180 LANCASTER RD
1903303027	2190 LANCASTER RD
1903303028	2200 LANCASTER RD
1903303029	2210 LANCASTER RD
1903303030	2220 LANCASTER RD
1903303031	2230 LANCASTER RD
1903303032	2240 LANCASTER RD
1903303033	2252 LANCASTER RD

PIN	ADDRESS
1903303034	2264 LANCASTER RD
1903303035	2276 LANCASTER RD
1903303036	2286 LANCASTER RD
1903304001	2175 LANCASTER RD
1903304002	2199 LANCASTER RD
1903304003	2211 LANCASTER RD
1903304004	2221 LANCASTER RD
1903304005	2231 LANCASTER RD
1903304006	2241 LANCASTER RD
1903304007	2251 LANCASTER RD
1903304008	2263 LANCASTER RD
1903304009	2275 LANCASTER RD
1903304010	2281 LANCASTER RD
1903304011	2295 LANCASTER RD
1903304012	385 MARLBOROUGH DR
1903304013	369 MARLBOROUGH DR
1903304014	351 MARLBOROUGH DR
1903304015	333 MARLBOROUGH DR
1903304016	309 MARLBOROUGH DR
1903304017	297 MARLBOROUGH DR
1903304018	275 MARLBOROUGH DR
1903304021	237 MARLBOROUGH DR
1903304022	223 MARLBOROUGH DR
1903304023	199 MARLBOROUGH DR
1903304025	265 MARLBOROUGH DR
1903304026	261 MARLBOROUGH DR
1903326001	2123 SOMERSET RD
1903326002	2143 SOMERSET RD
1903326003	2153 SOMERSET RD
1903326004	2163 SOMERSET RD
1903326005	2173 SOMERSET RD
1903326006	2183 SOMERSET RD
1903326007	VACANT
1903326010	2223 SOMERSET RD
1903326011	2233 SOMERSET RD
1903326012	2243 SOMERSET RD
1903326013	2253 SOMERSET RD
1903326014	2263 SOMERSET RD
1903326015	2273 SOMERSET RD
1903326016	2283 SOMERSET RD
1903326017	2293 SOMERSET RD
1903326018	2213 SOMERSET RD
1903327001	2128 SOMERSET RD
1903327002	2138 SOMERSET RD
1903327003	2148 SOMERSET RD
1903327004	2158 SOMERSET RD
1903327005	2168 SOMERSET RD
1903327006	2184 SOMERSET RD
1903327010	2218 SOMERSET RD
1903327011	2228 SOMERSET RD
1903327012	2238 SOMERSET RD
1903327013	2248 SOMERSET RD
1903327014	2258 SOMERSET RD
1903327015	2268 SOMERSET RD
1903327016	2278 SOMERSET RD
1903327017	2288 SOMERSET RD
1903327018	328 MARLBOROUGH DR
1903327019	316 MARLBOROUGH DR
1903327020	302 MARLBOROUGH DR
1903327021	290 MARLBOROUGH DR
1903327022	2241 BEDFORD RD
1903327023	2255 BEDFORD RD
1903327024	2265 BEDFORD RD
1903327025	2277 BEDFORD RD
1903327026	2295 BEDFORD RD
1903327027	2307 BEDFORD RD
1903327028	2317 BEDFORD RD
1903327029	2335 BEDFORD RD
1903327030	2198 SOMERSET RD
1903327031	2208 SOMERSET RD

PIN	ADDRESS
1903352005	54 HILLSDALE RD
1903352006	60 HILLSDALE RD
1903352007	66 HILLSDALE RD
1903352008	107 MARLBOROUGH DR
1903352026	VACANT
1903352027	95 MARLBOROUGH DR
1903352028	VACANT
1903352029	67 MARLBOROUGH DR
1903352030	53 MARLBOROUGH DR
1903352031	29 MARLBOROUGH DR
1903376001	268 MARLBOROUGH DR
1903376002	250 MARLBOROUGH DR
1903376003	238 MARLBOROUGH DR
1903376004	226 MARLBOROUGH DR
1903376005	214 MARLBOROUGH DR
1903376006	200 MARLBOROUGH DR
1903376007	2288 BEDFORD RD
1903376008	2300 BEDFORD RD
1903376009	2312 BEDFORD RD
1903376010	2447 DEVONSHIRE RD
1903376011	2467 DEVONSHIRE RD
1903376012	2332 RUTHERFORD RD
1903376013	2350 RUTHERFORD RD
1903376014	2362 RUTHERFORD RD
1903376015	2374 RUTHERFORD RD
1903376016	2386 RUTHERFORD RD
1903377001	VACANT
1903377002	158 MARLBOROUGH DR
1903377003	150 MARLBOROUGH DR
1903377004	130 MARLBOROUGH DR
1903377005	116 MARLBOROUGH DR
1903377006	106 MARLBOROUGH DR
1903377007	88 MARLBOROUGH DR
1903377008	2444 DEVONSHIRE RD
1903377009	2464 DEVONSHIRE RD
1903377014	105 BARRINGTON RD
1903377015	115 BARRINGTON RD
1903377016	125 BARRINGTON RD
1903377017	2406 RUTHERFORD RD
1903377018	2418 RUTHERFORD RD
1903377019	145 BARRINGTON RD
1903377020	85 BARRINGTON RD
1903378001	26 MARLBOROUGH DR
1903378002	28 BARRINGTON RD
1903378003	38 BARRINGTON RD
1903378004	50 BARRINGTON RD
1903378005	62 BARRINGTON RD
1903378006	74 BARRINGTON RD
1903378007	86 BARRINGTON RD
1903378008	96 BARRINGTON RD
1903378009	106 BARRINGTON RD
1903378010	116 BARRINGTON RD
1903378011	126 BARRINGTON RD
1903378012	136 BARRINGTON RD
1903378013	146 BARRINGTON RD
1903378014	156 BARRINGTON RD
1903379001	2285 RUTHERFORD RD
1903379002	2299 RUTHERFORD RD
1903379003	2311 RUTHERFORD RD
1903379004	2329 RUTHERFORD RD
1903379005	2347 RUTHERFORD RD
1903379006	2361 RUTHERFORD RD
1903379007	2373 RUTHERFORD RD
1903379008	2385 RUTHERFORD RD
1903379009	2395 RUTHERFORD RD
1903379010	2425 RUTHERFORD RD
1903379011	177 BARRINGTON RD
1903379012	195 BARRINGTON RD
1903379013	199 BARRINGTON RD
1903379014	201 BARRINGTON RD

PIN	ADDRESS
1903379018	2340 MULBERRY RD
1903379021	2376 MULBERRY RD
1903379022	2388 MULBERRY RD
1903379023	219 BARRINGTON RD
1903379024	211 BARRINGTON RD
1903379026	215 BARRINGTON RD
1903379027	2364 MULBERRY RD
1903380001	176 BARRINGTON RD
1903380002	188 BARRINGTON RD
1903380003	198 BARRINGTON RD

All in Bloomfield Township, Oakland County, Michigan.

PLEASE TAKE NOTICE that Bloomfield Township's Board of Trustees has tentatively declared its intention to make the following improvements:

The construction (and associated items) of the water main within the South Bloomfield Highlands Subdivision (see attached map) which consists of a total of 14,450 feet of 8" water main.

The project consists of installation of a new public 8" water main system that will replace an existing private well system throughout South Bloomfield Highlands. The water main will run down the public rights-of-way ("ROW") of the following roads within the subdivision: Barrington, Bedford, Devonshire, Hillsdale, Lancaster, Marlborough, Mulberry, Rutherford, Somerset, and Traymore. As part of the special assessment district ("SAD") there will be three water main connections to the existing Township public water system at the following locations: Barrington Road where the ROW meets Square Lake Road, Rutherford Road where it intersects Square Lake Road, and Mulberry Road just north of Square Lake Road. The project also includes a new 1" water tap off the new 8" water main that will extend to a stop box at the property line of each lot within South Bloomfield Highlands.

In addition, the Board of Trustees has tentatively designated the SAD against which the cost of said improvements is to be assessed as consisting of all lots and parcels of land as set forth above. The plans and estimates for the SAD are on file in the Clerk's Office, (248) 433-7702, at the Bloomfield Township Hall, 4200 Telegraph Road, Bloomfield Hills, MI 48302.

TAKE FURTHER NOTICE that the Board of Trustees will meet on **MONDAY, JANUARY 8, 2024, at 7:00 p.m.** in the auditorium at the Bloomfield Township Hall, address provided above, for the purpose of hearing any objections to the improvements, to the petition, or to the special assessment district therefor.

In order to appeal the amount of the special assessment to the state tax tribunal, your appearance and protest are required at the special assessment's hearing. Appearance and protest may be made by a property owner or party in interest, or his or her agent, in person, or such protest is permitted by letter, without the necessity of a personal appearance. Public comments can be e-mailed to publiccomment@bloomfieldtp.org or be mailed to the Clerk's Office, address provided above.



Watch BCTVLive



Agenda & Packet

Materials for the Board of Trustees meeting and public hearing will be made available to the public on the Township's [Documents on Demand webpage](#) by the close of business on Thursday, January 4, 2024. [Bloomfield Community Television](#) will broadcast the meeting on Comcast's channel 15 and AT&T's channel 99 for Bloomfield Township residents. The Quick Response ("QR") codes and links provided in this notice can be utilized to view the meeting's materials and live proceedings.

MARTIN C. BROOK
BLOOMFIELD TOWNSHIP CLERK

NOTE: The Charter Township of Bloomfield will provide necessary, reasonable auxiliary aids and services at all meetings to individuals with disabilities. All such requests must be made at least five days prior to said meeting. Individuals with disabilities requiring auxiliary aids or services should contact the Bloomfield Township Clerk's Office by writing or calling the following: Clerk's Office, 4200 Telegraph Road, Bloomfield Hills, MI 48302; by Telephone: 248-433-7702.

MAP OF THE TENTATIVE SPECIAL ASSESSMENT DISTRICT NO. 601

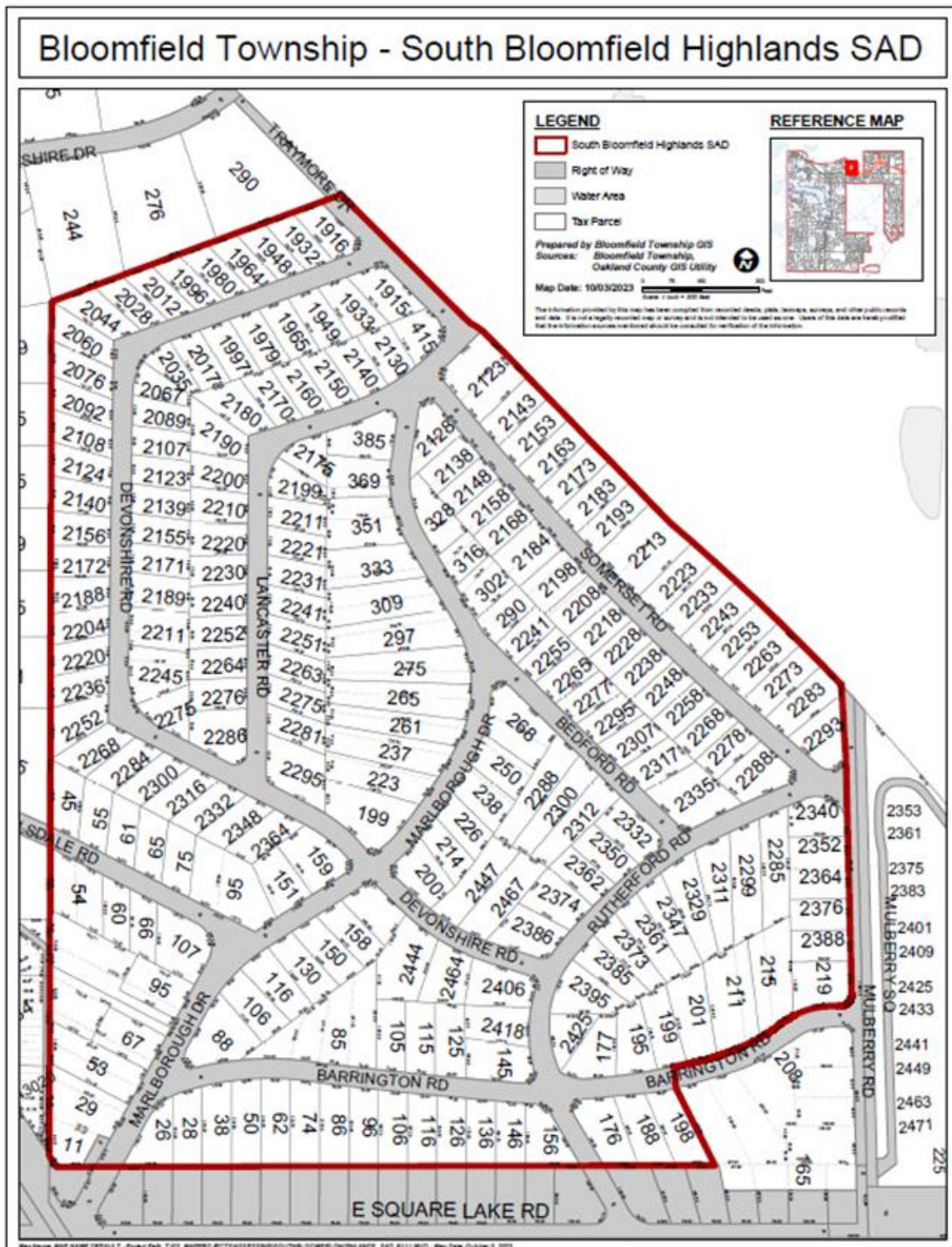

The preliminary project cost has been estimated to be \$8,534,323.56 with a tentative assessment amount of \$39,328.68 per full unit of benefit.