



**CHARTER TOWNSHIP OF BLOOMFIELD  
NOTICE OF HEARING OF NECESSITY  
ON SPECIAL ASSESSMENT IMPROVEMENTS**

**SUBDIVISION ROAD PAVING  
FOR THE ROADS WITHIN VERNOR ESTATES 1, 2, 3, PART OF JUDSON BRADWAY'S  
CHELMSLEIGH ADDITION TO COUNTRY CLUB ESTATES AND OVERBROOK WEST  
SUBDIVISION**

**SPECIAL ASSESSMENT DISTRICT NO. 431**

TO THE OWNERS OF THE FOLLOWING LISTED PROPERTIES:

<b>PIN</b>	<b>ADDRESS</b>	<b>PIN</b>	<b>ADDRESS</b>	<b>PIN</b>	<b>ADDRESS</b>
1916401009	4178 STONELEIGH RD	1916452023	4650 BRIGHTMORE RD	1916478003	4483 ARDMORE DR
1916401011	4050 STONELEIGH RD	1916452024	4642 BRIGHTMORE RD	1916478004	4495 ARDMORE DR
1916401012	4090 STONELEIGH RD	1916452025	4602 BRIGHTMORE RD	1916478005	4507 ARDMORE DR
1916401013	4120 STONELEIGH RD	1916452026	4590 BRIGHTMORE RD	1916478006	4409 ARDMORE DR
1916401014	4146 STONELEIGH RD	1916452027	4572 BRIGHTMORE RD	1916478007	4430 STONELEIGH RD
1916402017	4251 STONELEIGH RD	1916452028	4560 BRIGHTMORE RD	1916478008	4466 STONELEIGH RD
1916402018	4267 STONELEIGH RD	1916452029	4548 BRIGHTMORE RD	1916478009	4526 STONELEIGH RD
1916402019	4279 STONELEIGH RD	1916452030	4536 BRIGHTMORE RD	1916479001	4411 STONELEIGH RD
1916402020	4285 STONELEIGH RD	1916452031	4518 BRIGHTMORE RD	1916479002	4383 ARDMORE DR
1916402021	4291 STONELEIGH RD	1916452032	4506 BRIGHTMORE RD	1916479003	4365 ARDMORE DR
1916402022	4297 STONELEIGH RD	1916452033	4484 ARDMORE CT	1916479004	4341 ARDMORE DR
1916402023	4019 STONELEIGH RD	1916452036	4444 ARDMORE CT	1916479005	4327 ARDMORE DR
1916402024	4043 STONELEIGH RD	1916452037	4436 ARDMORE CT	1916479006	4429 STONELEIGH RD
1916402025	4067 STONELEIGH RD	1916452038	4428 ARDMORE CT	1916479007	4449 CONMOORE CT
1916402026	4091 STONELEIGH RD	1916452039	4408 ARDMORE DR	1916479008	4457 CONMOORE CT
1916402027	4123 STONELEIGH RD	1916452042	4452 ARDMORE CT	1916479009	4465 CONMOORE CT
1916402028	4147 STONELEIGH RD	1916452043	4472 ARDMORE CT	1916479010	4454 BARCHESTER DR
1916402029	4171 STONELEIGH RD	1916453001	4593 BRIGHTMORE RD	1916479011	4462 BARCHESTER DR
1916402030	4201 STONELEIGH RD	1916453002	4577 BRIGHTMORE RD	1916479012	4521 STONELEIGH RD
1916402031	4233 STONELEIGH RD	1916453003	4519 BRIGHTMORE RD	1916479013	4489 CONMOORE CT
1916451001	4322 VERNOR CT	1916453004	4507 BRIGHTMORE RD	1916479014	4481 CONMOORE CT
1916451002	4328 VERNOR CT	1916453005	4611 BRIGHTMORE CT	1916479015	4473 CONMOORE CT
1916451003	4334 VERNOR CT	1916453006	4526 ARDMORE DR	1916479016	4470 BARCHESTER DR
1916451004	4340 VERNOR CT	1916454001	4643 BRIGHTMORE RD	1916479017	4479 BARCHESTER DR
1916451005	4354 COMPTON WAY	1916476013	4311 STONELEIGH RD	1916479018	4447 BARCHESTER DR
1916451006	4362 COMPTON WAY	1916476014	4327 STONELEIGH RD	1916479019	4455 BARCHESTER DR
1916451007	4370 COMPTON WAY	1916476015	4343 STONELEIGH RD	1916479020	4459 BARCHESTER DR
1916451008	4378 COMPTON WAY	1916476016	4357 BARCHESTER DR	1916479021	4463 BARCHESTER DR
1916451009	4316 VERNOR CT	1916476017	4363 BARCHESTER DR	1921201001	979 SANDHURST RD
1916451010	4310 VERNOR CT	1916476018	4369 BARCHESTER DR	1921201002	967 SANDHURST RD
1916451011	4298 COMPTON WAY	1916476019	4375 BARCHESTER DR	1921201003	4678 BRIGHTMORE RD
1916451012	4252 STONELEIGH RD	1916476020	4381 BARCHESTER DR	1921201004	4686 BRIGHTMORE RD
1916451013	4258 STONELEIGH RD	1916476021	4387 BARCHESTER DR	1921201005	4692 BRIGHTMORE RD
1916452001	4386 COMPTON WAY	1916476022	4393 BARCHESTER DR	1921201006	4695 BRIGHTMORE RD
1916452002	4389 COMPTON WAY	1916476023	4403 BARCHESTER DR	1921201007	4689 BRIGHTMORE RD
1916452003	4377 COMPTON WAY	1916476024	4411 BARCHESTER DR	1921201008	4683 BRIGHTMORE RD
1916452004	4365 COMPTON WAY	1916476025	4419 BARCHESTER DR	1921201009	927 SANDHURST RD
1916452005	4351 COMPTON WAY	1916476026	4427 BARCHESTER DR	1921201010	905 SANDHURST RD
1916452006	4331 COMPTON WAY	1916476027	4435 BARCHESTER DR	1921201011	4678 ARDMORE DR
1916452007	4299 COMPTON WAY	1916477001	4359 STONELEIGH RD	1921202001	4653 BRIGHTMORE RD
1916452008	4275 COMPTON WAY	1916477002	4364 BARCHESTER DR	1921202002	4627 BRIGHTMORE CT
1916452009	4270 STONELEIGH RD	1916477003	4370 BARCHESTER DR	1921202003	4619 BRIGHTMORE CT
1916452010	4276 STONELEIGH RD	1916477004	4376 BARCHESTER DR	1921202004	4538 ARDMORE DR
1916452011	4282 STONELEIGH RD	1916477005	4380 BARCHESTER DR	1921202005	4665 BRIGHTMORE RD
1916452012	4288 STONELEIGH RD	1916477006	4388 BARCHESTER DR	1921202006	920 SANDHURST RD
1916452013	4296 STONELEIGH RD	1916477007	4373 STONELEIGH RD	1921202007	900 SANDHURST RD
1916452014	4302 STONELEIGH RD	1916477008	4385 STONELEIGH RD	1921202008	4600 ARDMORE DR
1916452015	4318 STONELEIGH RD	1916477009	4366 ARDMORE DR	1921202009	4564 ARDMORE DR
1916452016	4334 STONELEIGH RD	1916477010	4358 ARDMORE DR	1921202010	4550 ARDMORE DR
1916452017	4350 STONELEIGH RD	1916477011	4350 ARDMORE DR	1921203001	4523 ARDMORE DR
1916452018	4368 STONELEIGH RD	1916477012	4334 ARDMORE DR	1921203002	4539 ARDMORE DR
1916452019	980 SANDHURST RD	1916477013	4424 BARCHESTER DR	1921203003	4551 ARDMORE DR
1916452020	968 SANDHURST RD	1916477014	4326 ARDMORE DR	1921203004	4601 ARDMORE DR
1916452021	4666 BRIGHTMORE RD	1916478001	4423 ARDMORE DR	1921203005	4651 ARDMORE DR
1916452022	4658 BRIGHTMORE RD	1916478002	4471 ARDMORE DR		

All in Bloomfield Township, Oakland County, Michigan.

PLEASE TAKE NOTICE that the Township Board of the Charter Township of Bloomfield has tentatively declared its intention to make the following improvements:

The paving (and associated construction items) of the roads within within Vernor Estates 1, 2 & 3, Part of Judson Bradway's Chelmsleigh Addition to Country Club Estates and Overbrook West Subdivision (see attached map) which consists of a total of 2.90 miles of roadway.

The project consists of pulverizing the existing road and four-inch bituminous (asphalt) pavement will be placed over aggregate base with full depth cold milling asphalt removal. Total curb and gutter removal and replacement, total underdrain installation with sodded shoulders and minor drainage improvements to reasonably assure drainage of the pavement surface. A maximum five (5) foot approach will be constructed to existing driveways to provide smooth transition from the newly paved roadway where necessary.

In addition, the Township Board has tentatively designated the special assessment district against which the cost of said improvements is to be assessed as consisting of all lots and parcels of land as set forth above. The plans and estimates for the special assessment district are on file in the Bloomfield Township Clerk's Office, 4200 Telegraph Road, Bloomfield Hills, MI 48302.

TAKE FURTHER NOTICE that the Township Board will meet on **Monday, February 24, 2025, at 7:00 p.m.**, in the Community Television Building studio, due to auditorium renovations at Township Hall. Address being 4190 Dublin Road, Bloomfield Hills, MI 48302, for the purpose of hearing any objections to the improvements, to the petition, or to the special assessment district therefor.

In order to appeal the amount of the special assessment to the state tax tribunal, your appearance and protest are required at the Hearing in the Special Assessment Proceedings. Appearance and protest may be made by a property owner or party in interest, or his or her agent, in person, or such protest is permitted by letter, without the necessity of a personal appearance.



 Watch BCTV Live



 Agenda & Packet

Materials for the Board meeting and Public Hearing of Necessity will be made available to the public on the Township's [Documents on Demand webpage](#) by the close of business on Thursday, February 20, 2025. [Bloomfield Community Television](#) will broadcast the meeting on Comcast's channel 15 and AT&T's channel 99 for Bloomfield Township residents. The Quick Response ("QR") codes and links provided in this notice can be utilized to view the meeting's materials and live proceedings.

**MARTIN C. BROOK  
BLOOMFIELD TOWNSHIP CLERK**

MAP OF THE TENTATIVE SPECIAL ASSESSMENT DISTRICT #431

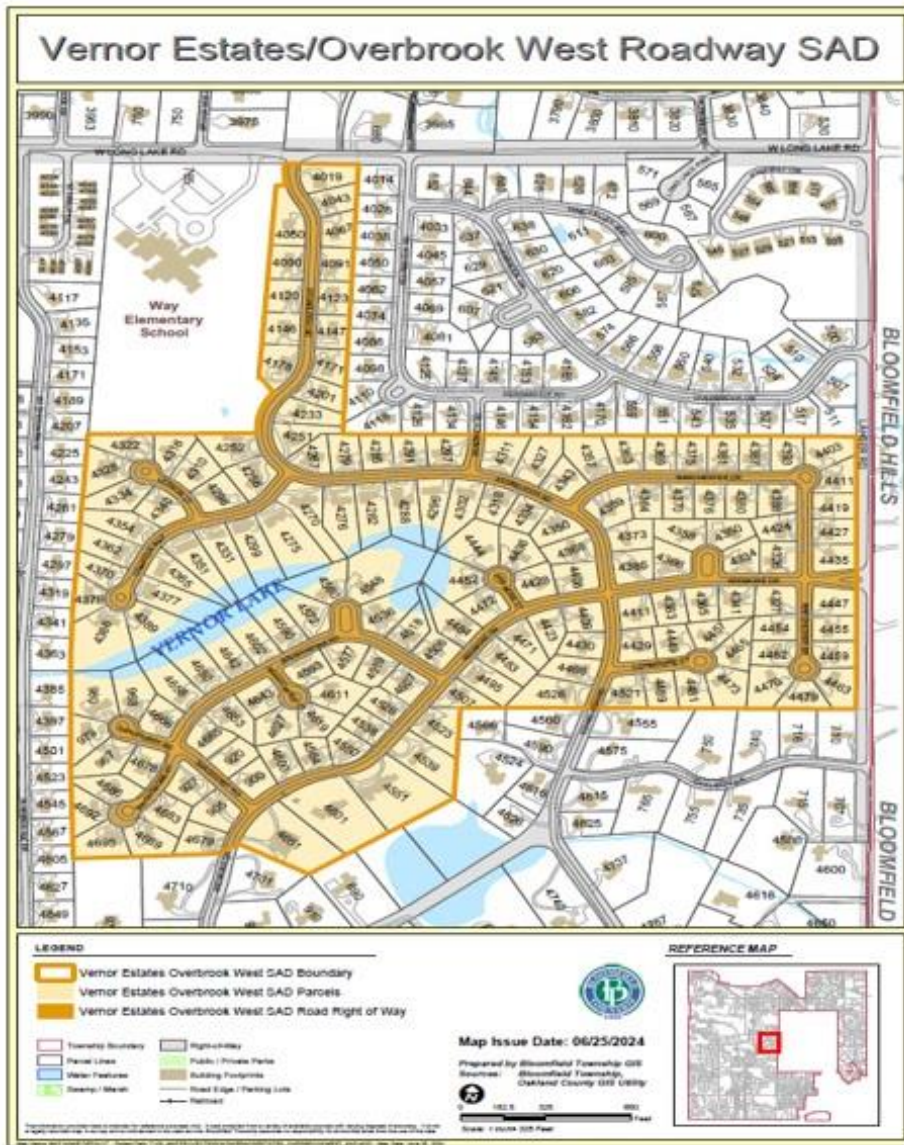

The tentative assessment for the improvements is \$3,885,585.40, which is \$24,302.35 per full unit of benefit.

Posted on Website: February 6, 2025