



**CHARTER TOWNSHIP OF BLOOMFIELD**  
**NOTICE OF HEARING ON SPECIAL ASSESSMENT ROLL**  
**PUBLIC WATER MAIN PROJECT FOR SOUTH BLOOMFIELD HIGHLANDS SUBDIVISION**  
**SPECIAL ASSESSMENT DISTRICT NO. 601**

TO THE OWNERS OF THE FOLLOWING LISTED PROPERTIES:

The project cost is \$5,425,161.84  
with an assessment amount of \$25,116.49 per parcel.

Parcel #	Address	Street
1903302013	1916	DEVONSHIRE RD
1903302014	1932	DEVONSHIRE RD
1903302015	1948	DEVONSHIRE RD
1903302016	1964	DEVONSHIRE RD
1903302017	1980	DEVONSHIRE RD
1903302018	1996	DEVONSHIRE RD
1903302019	2012	DEVONSHIRE RD
1903302020	2028	DEVONSHIRE RD
1903302021	2044	DEVONSHIRE RD
1903302022	2060	DEVONSHIRE RD
1903302023	2076	DEVONSHIRE RD
1903302026	2124	DEVONSHIRE RD
1903302027	2140	DEVONSHIRE RD
1903302028	2156	DEVONSHIRE RD
1903302029	2172	DEVONSHIRE RD
1903302030	2188	DEVONSHIRE RD
1903302031	2204	DEVONSHIRE RD
1903302032	2220	DEVONSHIRE RD
1903302033	2236	DEVONSHIRE RD
1903302034	2252	DEVONSHIRE RD
1903302035	2268	DEVONSHIRE RD
1903302036	2284	DEVONSHIRE RD
1903302037	2300	DEVONSHIRE RD
1903302038	2316	DEVONSHIRE RD
1903302039	2332	DEVONSHIRE RD
1903302040	2348	DEVONSHIRE RD
1903302041	2364	DEVONSHIRE RD
1903302042	45	HILLSDALE RD
1903302043	55	HILLSDALE RD
1903302044	61	HILLSDALE RD
1903302045	65	HILLSDALE RD
1903302046	75	HILLSDALE RD
1903302047	95	HILLSDALE RD
1903302050	151	MARLBOROUGH DR

Parcel #	Address	Street
1903302051	159	MARLBOROUGH DR
1903302052	2092	DEVONSHIRE RD
1903303001	1915	DEVONSHIRE RD
1903303002	1933	DEVONSHIRE RD
1903303003	1949	DEVONSHIRE RD
1903303004	1965	DEVONSHIRE RD
1903303005	1979	DEVONSHIRE RD
1903303006	1997	DEVONSHIRE RD
1903303007	2017	DEVONSHIRE RD
1903303008	2035	DEVONSHIRE RD
1903303009	2067	DEVONSHIRE RD
1903303010	2089	DEVONSHIRE RD
1903303011	2107	DEVONSHIRE RD
1903303012	2123	DEVONSHIRE RD
1903303013	2139	DEVONSHIRE RD
1903303014	2155	DEVONSHIRE RD
1903303015	2171	DEVONSHIRE RD
1903303016	2189	DEVONSHIRE RD
1903303017	2211	DEVONSHIRE RD
1903303018	2245	DEVONSHIRE RD
1903303019	2275	DEVONSHIRE RD
1903303020	415	MARLBOROUGH DR
1903303021	2130	LANCASTER RD
1903303022	2140	LANCASTER RD
1903303023	2150	LANCASTER RD
1903303024	2160	LANCASTER RD
1903303025	2170	LANCASTER RD
1903303026	2180	LANCASTER RD
1903303027	2190	LANCASTER RD
1903303028	2200	LANCASTER RD
1903303029	2210	LANCASTER RD
1903303030	2220	LANCASTER RD
1903303031	2230	LANCASTER RD
1903303032	2240	LANCASTER RD

Parcel #	Address	Street
1903303033	2252	LANCASTER RD
1903303034	2264	LANCASTER RD
1903303035	2276	LANCASTER RD
1903303036	2286	LANCASTER RD
1903304001	2175	LANCASTER RD
1903304002	2199	LANCASTER RD
1903304003	2211	LANCASTER RD
1903304004	2221	LANCASTER RD
1903304005	2231	LANCASTER RD
1903304006	2241	LANCASTER RD
1903304007	2251	LANCASTER RD
1903304008	2263	LANCASTER RD
1903304009	2275	LANCASTER RD
1903304010	2281	LANCASTER RD
1903304011	2295	LANCASTER RD
1903304012	385	MARLBOROUGH DR
1903304013	369	MARLBOROUGH DR
1903304014	351	MARLBOROUGH DR
1903304015	333	MARLBOROUGH DR
1903304016	309	MARLBOROUGH DR
1903304017	297	MARLBOROUGH DR
1903304018	275	MARLBOROUGH DR
1903304021	237	MARLBOROUGH DR
1903304022	223	MARLBOROUGH DR
1903304023	199	MARLBOROUGH DR
1903304025	265	MARLBOROUGH DR
1903304026	261	MARLBOROUGH DR
1903326001	2123	SOMERSET RD
1903326002	2143	SOMERSET RD
1903326003	2153	SOMERSET RD
1903326004	2163	SOMERSET RD
1903326005	2173	SOMERSET RD
1903326010	2223	SOMERSET RD
1903326011	2233	SOMERSET RD

Parcel #	Address	Street
1903326012	2243	SOMERSET RD
1903326013	2253	SOMERSET RD
1903326014	2263	SOMERSET RD
1903326015	2273	SOMERSET RD
1903326016	2283	SOMERSET RD
1903326017	2293	SOMERSET RD
1903326018	2213	SOMERSET RD
1903326019	2183	SOMERSET RD
1903327001	2128	SOMERSET RD
1903327002	2138	SOMERSET RD
1903327003	2148	SOMERSET RD
1903327004	2158	SOMERSET RD
1903327005	2168	SOMERSET RD
1903327006	2184	SOMERSET RD
1903327010	2218	SOMERSET RD
1903327011	2228	SOMERSET RD
1903327012	2238	SOMERSET RD
1903327013	2248	SOMERSET RD
1903327014	2258	SOMERSET RD
1903327015	2268	SOMERSET RD
1903327016	2278	SOMERSET RD
1903327017	2288	SOMERSET RD
1903327018	328	MARLBOROUGH DR
1903327019	316	MARLBOROUGH DR
1903327020	302	MARLBOROUGH DR
1903327021	290	MARLBOROUGH DR
1903327022	2241	BEDFORD RD
1903327023	2255	BEDFORD RD
1903327024	2265	BEDFORD RD
1903327025	2277	BEDFORD RD
1903327026	2295	BEDFORD RD
1903327027	2307	BEDFORD RD
1903327028	2317	BEDFORD RD
1903327029	2335	BEDFORD RD

Parcel #	Address	Street
1903327030	2198	SOMERSET RD
1903327031	2208	SOMERSET RD
1903352005	54	HILLSDALE RD
1903352006	60	HILLSDALE RD
1903352007	66	HILLSDALE RD
1903352008	107	MARLBOROUGH DR
1903352027	95	MARLBOROUGH DR
1903352029	67	MARLBOROUGH DR
1903352030	53	MARLBOROUGH DR
1903352031	29	MARLBOROUGH DR
1903352032		VACANT PARCEL
1903376001	268	MARLBOROUGH DR
1903376002	250	MARLBOROUGH DR
1903376003	238	MARLBOROUGH DR
1903376004	226	MARLBOROUGH DR
1903376005	214	MARLBOROUGH DR
1903376006	200	MARLBOROUGH DR
1903376007	2288	BEDFORD RD
1903376008	2300	BEDFORD RD
1903376009	2312	BEDFORD RD
1903376010	2447	DEVONSHIRE RD
1903376011	2467	DEVONSHIRE RD
1903376012	2332	RUTHERFORD RD
1903376013	2350	RUTHERFORD RD
1903376014	2362	RUTHERFORD RD
1903376015	2374	RUTHERFORD RD
1903376016	2386	RUTHERFORD RD
1903377001		VACANT PARCEL
1903377002	158	MARLBOROUGH DR
1903377005	116	MARLBOROUGH DR
1903377006	106	MARLBOROUGH DR
1903377007	88	MARLBOROUGH DR
1903377008	2444	DEVONSHIRE RD
1903377009	2464	DEVONSHIRE RD

Parcel #	Address	Street
1903377014	105	BARRINGTON RD
1903377015	115	BARRINGTON RD
1903377016	125	BARRINGTON RD
1903377017	2406	RUTHERFORD RD
1903377018	2418	RUTHERFORD RD
1903377019	145	BARRINGTON RD
1903377020	85	BARRINGTON RD
1903377021	150	MARLBOROUGH DR
1903378001	26	MARLBOROUGH DR
1903378002	28	BARRINGTON RD
1903378003	38	BARRINGTON RD
1903378004	50	BARRINGTON RD
1903378005	62	BARRINGTON RD
1903378006	74	BARRINGTON RD
1903378007	86	BARRINGTON RD
1903378008	96	BARRINGTON RD
1903378009	106	BARRINGTON RD
1903378010	116	BARRINGTON RD
1903378011	126	BARRINGTON RD
1903378012	136	BARRINGTON RD
1903378013	146	BARRINGTON RD
1903378014	156	BARRINGTON RD
1903379001	2285	RUTHERFORD RD
1903379002	2299	RUTHERFORD RD
1903379003	2311	RUTHERFORD RD
1903379004	2329	RUTHERFORD RD
1903379005	2347	RUTHERFORD RD
1903379006	2361	RUTHERFORD RD
1903379007	2373	RUTHERFORD RD
1903379008	2385	RUTHERFORD RD
1903379009	2395	RUTHERFORD RD
1903379010	2425	RUTHERFORD RD
1903379011	177	BARRINGTON RD
1903379012	195	BARRINGTON RD
1903379013	199	BARRINGTON RD
1903379014	201	BARRINGTON RD
1903379018	2340	MULBERRY RD
1903379021	2376	MULBERRY RD
1903379022	2388	MULBERRY RD
1903379023	219	BARRINGTON RD
1903379024	211	BARRINGTON RD
1903379026	215	BARRINGTON RD
1903379027	2364	MULBERRY RD
1903380001	176	BARRINGTON RD
1903380002	188	BARRINGTON RD
1903380003	198	BARRINGTON RD

All in Bloomfield Township, Oakland County, Michigan.

**PLEASE TAKE NOTICE** that Bloomfield Township's Board of Trustees has declared its intention to make the following improvements:

The construction (and associated items) of the water main within the South Bloomfield Highlands Subdivision (see attached map) which consists of a total of 14,450 feet of 8" water main.

The project consists of installation of a new public 8" water main system that will replace an existing private well system throughout South Bloomfield Highlands. The water main will run down the public rights-of-way ("ROW") of the following roads within the subdivision: Barrington, Bedford, Devonshire, Hillsdale, Lancaster, Marlborough, Mulberry, Rutherford, Somerset, and Traymore. As part of the special assessment district ("SAD") there will be three water main connections to the existing Township public water system at the following locations: Barrington Road where the ROW meets Square Lake Road, Rutherford Road where it intersects Square Lake Road, and Mulberry Road just north of Square Lake Road. The project also includes a new 1" water tap off the new 8" water main that will extend to a stop box at the property line of each lot within South Bloomfield Highlands.

In addition, the Board of Trustees has designated the SAD against which the cost of said improvements is to be assessed as consisting of all lots and parcels of land as set forth above. The plans and special assessment roll for the SAD are on file in the Clerk's Office, (248) 433-7702, at the Bloomfield Township Hall, 4200 Telegraph Road, Bloomfield Hills, MI 48302.

**TAKE FURTHER NOTICE** that the Board of Trustees will meet on **MONDAY, SEPTEMBER 23, 2024, at 7:00 p.m.**, in the auditorium at the Bloomfield Township Hall, address provided above, for the purpose of hearing any objections to the possible confirmation of the Special Assessment Roll.

In order to appeal the amount of the special assessment to the state tax tribunal, your appearance and protest are required at the special assessment roll hearing. Appearance and protest may be made by a property owner or party in interest, or his or her agent, in person, or such protest is permitted by letter, without the necessity of a personal appearance. Public comments can be e-mailed to [publiccomment@bloomfieldtwp.org](mailto:publiccomment@bloomfieldtwp.org) or be mailed to the Clerk's Office, address provided above.



Materials for the Board of Trustees meeting and public hearing will be made available to the public on the Township's [Documents on Demand webpage](#) by the close of business on Thursday, September 19, 2024. [Bloomfield Community Television](#) will broadcast the meeting on Comcast's channel 15 and AT&T's channel 99 for Bloomfield Township residents. The Quick Response ("QR") codes and links provided in this notice can be utilized to view the meeting's materials and live proceedings.

**MARTIN C. BROOK**  
**BLOOMFIELD TOWNSHIP CLERK**

NOTE: The Charter Township of Bloomfield will provide necessary, reasonable auxiliary aids and services at all meetings to individuals with disabilities. All such requests must be made at least five days prior to said meeting. Individuals with disabilities requiring auxiliary aids or services should contact the Bloomfield Township Clerk's Office by writing or calling the following: Clerk's Office, 4200 Telegraph Road, Bloomfield Hills, MI 48302; by Telephone: 248-433-7702.

MAP OF THE TENTATIVE SPECIAL ASSESSMENT DISTRICT NO. 601

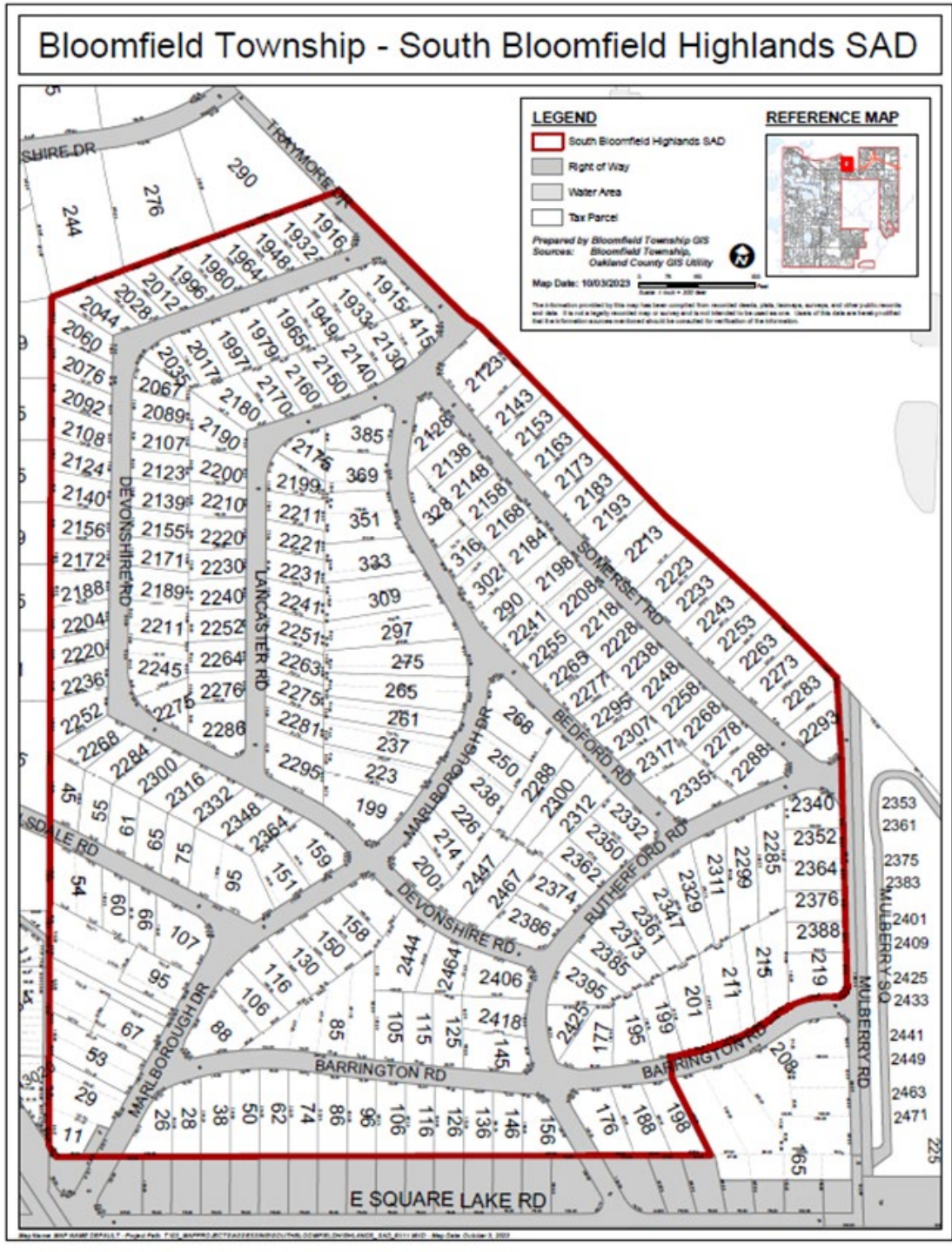

Published: September 5, 2024